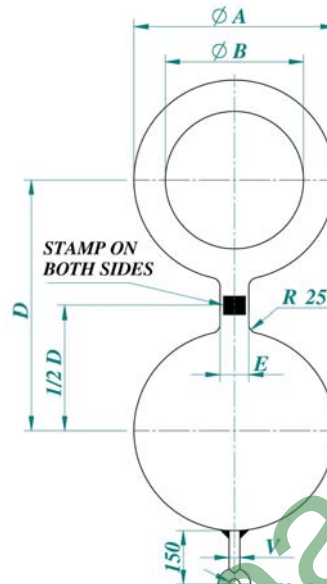

Class 150

Diameter (inches)	A	B	C	D	E	T	V	Unit	Unit	Unit
								weight	weight	weight
								spade	spacer	spectacle
								kg	kg	kg
2"	100	55	120	165	40	6	-	1	1	1
3"	130	80	140	205	40	7	-	1	1	1
4"	170	105	160	240	40	9	-	1	1	2
6"	215	155	185	290	40	11	-	3	1	4
8"	275	205	230	355	50	14	-	7	3	9
10"	335	255	260	420	50	17	-	12	4	13
12"	405	310	310	495	65	19	12	20	8	28
14"	445	345	335	545	65	21	12	25	11	36
16"	510	395	370	610	65	23	16	38	17	56
18"	545	440	385	650	65	26	16	48	18	66
20"	600	490	420	710	65	28	16	67	23	90
22"	655	545	445	760	65	32	20	84	27	111
24"	710	595	470	825	65	34	20	110	36	146
26"	770	645	505	885	65	36	20	136	44	180
28"	825	695	535	940	55	38	20	163	52	215
30"	875	745	560	1000	65	41	20	215	64	278
32"	935	795	600	1075	65	43	24	244	71	314
34"	985	850	625	1125	55	46	24	281	77	358
36"	1040	900	655	1180	65	48	24	345	91	435
38"	1105	950	690	1250	65	51	24	412	114	526
40"	1155	1000	715	1300	65	53	24	478	125	603
42"	1215	1050	745	1360	65	56	24	549	145	694
44"	1270	1100	775	1415	55	58	28	616	157	773
46"	1320	1150	800	1465	65	61	28	657	164	821
48"	1380	1205	825	1525	55	64	28	718	173	891

150 AD-036633/R.24

Class 300

Diameter (inches)	A	B	C	D	E	T	V	Unit	Unit	Unit
								weight	weight	weight
								kg	kg	kg
2"	105	55	115	190	25	8	-	1	1	1
3"	145	80	150	220	40	10	-	1	1	2
4"	175	105	180	265	45	12	-	2	2	3
6"	245	155	210	330	45	17	-	5	3	8
8"	300	205	240	395	45	21	12	14	8	22
10"	355	255	275	455	45	25	12	21	10	31
12"	415	310	310	535	45	29	12	34	16	50
14"	480	345	345	595	45	32	16	52	27	79
16"	535	395	375	660	45	36	20	67	32	99
18"	590	440	405	725	45	40	20	96	43	139
20"	650	490	445	785	50	44	20	128	56	184
22"	700	545	475	850	50	48	20	157	64	220
24"	770	595	525	925	65	52	20	212	88	300
26"	-	-	-	-	-	-	-	-	-	-
28"	-	-	-	-	-	-	-	-	-	-
30"	945	745	615	1105	65	65	24	447	183	630
32"	1000	795	640	1160	65	69	24	479	183	662
34"	1050	850	675	1220	65	73	24	570	202	772
36"	1110	900	705	1285	60	78	28	674	239	913
38"	1160	950	730	1340	65	79	32	764	262	1026
40"	1220	1000	760	1395	55	83	32	875	293	1168
42"	1285	1050	795	1460	60	87	32	1007	335	1342
44"	1340	1100	825	1520	65	91	32	1153	375	1528
46"	1395	1150	850	1575	60	95	32	1318	420	1738
48"	1485	1205	900	1665	65	100	32	1545	542	2087

AD-036731/R.21

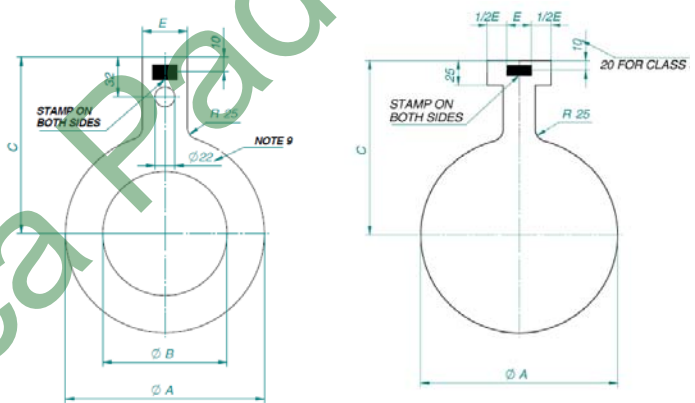
Class 600

Diameter (inches)	A	B	C	D	E	T	V	Unit	Unit	Unit
								weight	weight	weight
								kg	kg	kg
2"	105	55	130	180	25	10	-	1	1	1
3"	145	75	150	220	40	14	-	2	1	3
4"	185	100	180	285	40	22	-	4	2	6
6"	260	150	235	370	40	27	-	10	7	16
8"	315	195	265	435	40	27	12	18	11	38
10"	395	255	320	520	40	33	16	35	22	53
12"	450	305	345	570	40	39	16	57	32	89
14"	485	335	370	615	40	43	20	74	43	117
16"	560	385	415	700	50	48	20	110	60	170
18"	605	440	445	755	50	55	20	145	75	220
20"	675	490	485	825	50	60	20	202	101	303
22"	725	540	510	885	50	66	25	250	118	368
24"	785	590	545	950	50	72	25	318	147	465
26"	860	640	585	1030	50	79	25	407	183	590
28"	910	690	610	1085	50	84	25	491	204	695
30"	965	745	650	1145	50	91	25	596	247	843
32"	1015	795	675	1202	55	97	28	712	285	997
34"	1065	845	700	1260	60	102	32	837	321	1158
36"	1125	895	735	1325	60	108	32	973	365	1338
38"	1180	945	760	1385	65	112	32	1103	405	1508
40"	1220	995	785	1435	65	119	32	1280	437	1717
42"	1290	1050	825	1505	70	125	32	1477	514	1990
44"	1340	1100	865	1575	70	131	32	1682	567	2249
46"	1395	1150	890	1640	75	137	32	1907	634	2540
48"	1455	1200	915	1675	75	139	32	2147	702	2849

AD-036636/R.17

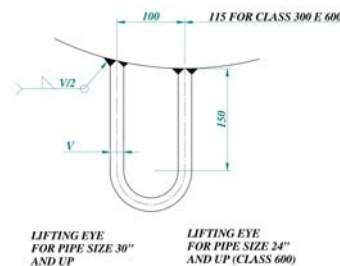
Notes:

- 1) Spectacle plates, blinds and spacers are to be made from A-105 or equal with specified minimum yield strength of 248.2 MPA.
- 2) To obtain the maximum P/SE ratio thickness "T" is calculated per ASME B31.3 par 304.5.3 with:

	P.Mpa	SE.Mpa
Class 150	3.1	223.4
Class 300	7.76	116.5
Class 600	10.34	116.5

Flange material is ASME B16.5 material group no.1.

3) Tolerances: diameters "A" & "B": +1,5 mm -1,5 mm thickness "T": +1,5 mm -0,25

4) Lifting eye is to be formed from the steelrod of composition similar to that of the plate. Commercial standars eyebolt may be used if they have the required dimension and material composition.

5) Gasket contact surfaces (area between diameters "A" & "B") shall have a surface finish roughness in the range between 3.2 and 6.4 um AARRH (se ASME B46.1) as judged by visual comparison. Flange surfaces shall be parallel.

6) Spectacle plates may be fabricated by welding two section together. Welding shall be 100% penetration by a procedure approved before fabrication.

7) Edges of blinds to be free from rough burn finish and burrs.

8) Stamp size and class 150/300/600 in 8 mm letters where indicated on drawing, on both sides of plate.

9) Hole dia 16 mm for 2"